

HERSEY GROVE  
FERRY BEACH PARK  
ASSOCIATION  
Updated 5/13/2009 5:04:00 PM

Area  
"B"

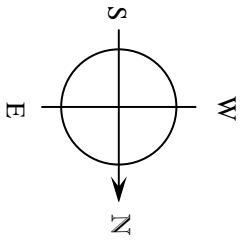
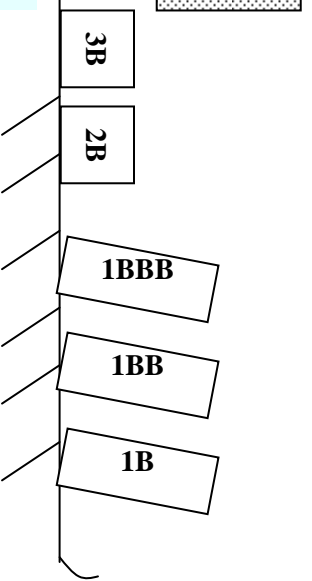

**Legend**

- Guest Camp Site
- ▨ Unavailable (seasonal site)
- ▨ Unavailable (staff housing site)

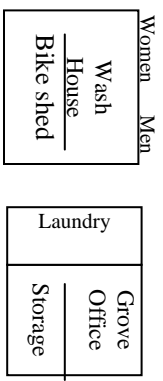
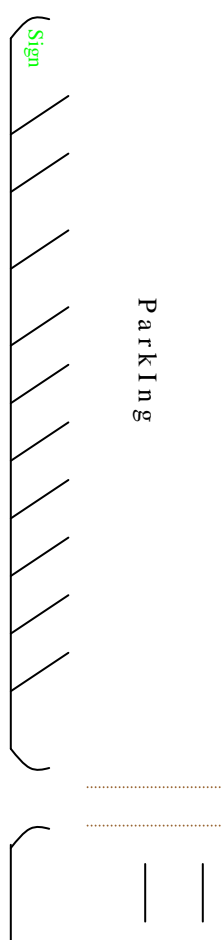
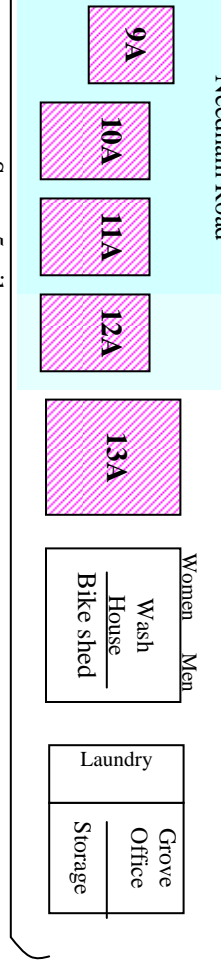
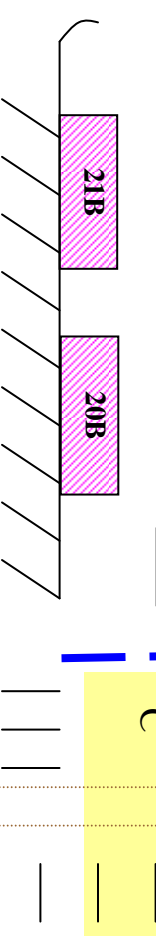
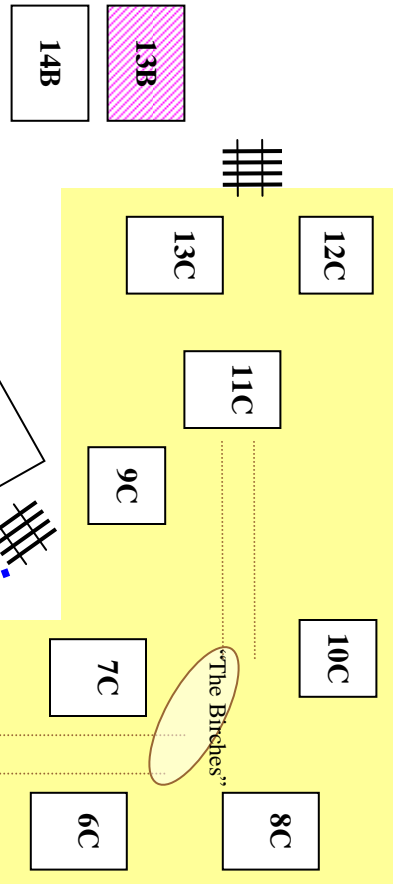

Saco - 5 miles

Route 9

To Quillen/Registration

Ferry Park Ave

Old Orchard Beach - 3 miles

Morris Ave.

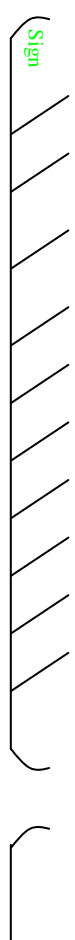

"Hopkins Way" (For tenting overflow only)

"The Breeches"

"Needham Road"

"Skunk Hollow"